

**Canon**

### **LASER CLASS® 700** Series

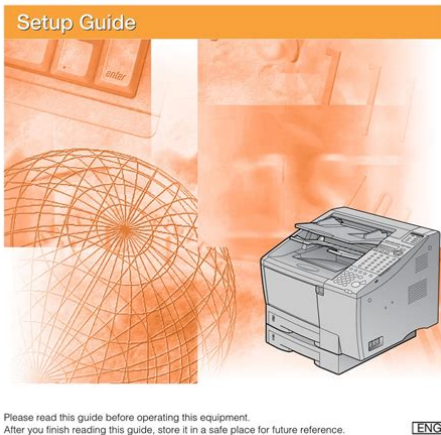

**File Name:** canon laser class 700 series manual.pdf

**Size:** 1660 KB

**Type:** PDF, ePub, eBook

**Category:** Book

**Uploaded:** 18 May 2019, 17:33 PM

**Rating:** 4.6/5 from 806 votes.

**Status:** AVAILABLE

Last checked: 3 Minutes ago!

**In order to read or download canon laser class 700 series manual ebook, you need to create a FREE account.**

**[Download Now!](#)**

eBook includes PDF, ePub and Kindle version

[Register a free 1 month Trial Account.](#)

[Download as many books as you like \(Personal use\)](#)

[Cancel the membership at any time if not satisfied.](#)

[Join Over 80000 Happy Readers](#)

### **Book Descriptions:**

We have made it easy for you to find a PDF Ebooks without any digging. And by having access to our ebooks online or by storing it on your computer, you have convenient answers with canon laser class 700 series manual . To get started finding canon laser class 700 series manual , you are right to find our website which has a comprehensive collection of manuals listed.

Our library is the biggest of these that have literally hundreds of thousands of different products represented.



## Book Descriptions:

# canon laser class 700 series manual

**Canon**

## **LASER CLASS® 700** Series

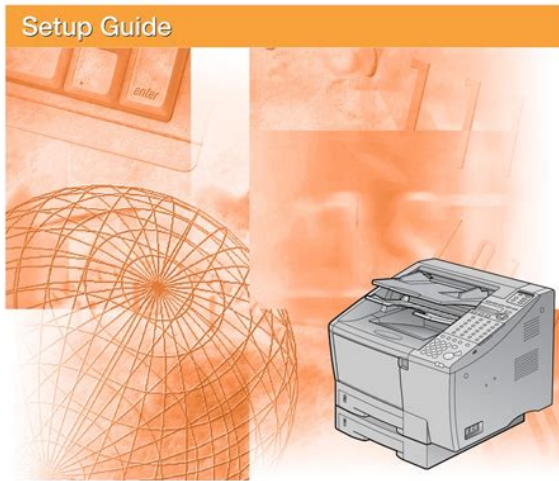

Please read this guide before operating this equipment.  
After you finish reading this guide, store it in a safe place for future reference.

ENG

Please refer to them for detailed information. The manuals supplied with optional equipment are included in the list below. Guides with this symbol are PDF manuals included on the Guides with this symbol are printed manuals. Considerable effort has been made to ensure that this manual is free of inaccuracies and omissions. Please read this manual thoroughly before operating the machine in order to familiarize yourself with its capabilities, and to make the most of its many functions. After reading this manual, store it in a safe place for future reference. The model LASER CLASS 710 is used for illustration purposes in this manual. These limits are designed to provide reasonable protection against harmful interference when the equipment is operated in a commercial environment. A nonexhaustive list of these documents is set forth below. If these items are dropped or spilled inside the machine, immediately disconnect the power cord from the power outlet. If these items are dropped or spilled inside the machine, immediately disconnect the power cord from the power outlet. If the toner gets into your eyes or mouth, wash them immediately with cold water and immediately consult a physician. UHQ Ultra High Quality Image Canon's ultra high quality image processing produces excellent reproductions of the documents you send and copy. Quality Images! OneTouch Speed Dial 1 2 8 Coded Speed Dial Variety of Send and Receive Features. Economical and Quiet Canon's RAPID Fusing System realizes quiet operation while you save money. For better security, PIN codes are not displayed on the LCD display during dialing only a. Either line can be used independently or simultaneously for separate transactions. For details, contact your local authorized Canon dealer. Do not use or store the machine outdoors. Place the machine near a telephone line. You must have an RJ11C wall jack installed. If you need assistance, contact your local authorized Canon dealer, or your local telephone company. <http://abugfreemind.com/userfiles/drivers-ed-manual-pa.xml>

- 1.0.

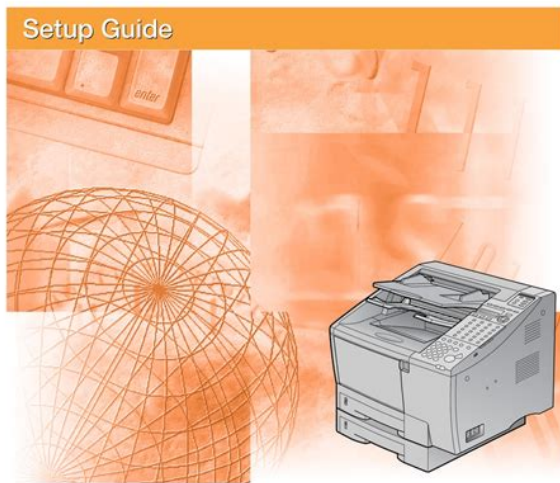
**LASER CLASS® 700 Series**

Please read this guide before operating this equipment.  
After you finish reading this guide, store it in a safe place for future reference.

ENG

This machine is intended for domestic use. Do not attempt to use it outside the country where you purchased it. Do not plug the power cord into an extension cord connector or power strip shared with other plugs. Do not set the machine, other equipment, or furniture on the power cord. As you unpack the machine, save the carton and packing material in case you want to move or ship the machine in the future. Ask someone to help you remove all the items from the box. CAUTION Lifting the main unit requires two people. Remove the four polystyrene plastic blocks positioned on top of the main unit. Document Output Tray Document Feeder Tray Telephone Line. Lift and remove the top carton. The shipping material is attached inside the main unit and inside the paper cassettes to protect delicate parts from vibrations during shipping. Orange Stopper Orange Stopper IMPORTANT Be sure to remove the orange stoppers. Close the ADF cover. Open the printer cover and the MP tray. Printer Cover MP Tray Removing the Shipping Material. Close the printer cover and the MP tray. IMPORTANT When removing the packaging material from inside the printer area, be careful not to touch the transfer charging roller. Pull out the paper cassette, and remove it from the machine. Remove the tape and orange key attached to the paper cassette. Attach the label here. Reinsert the paper cassette into the machine. For more details on how to reinsert the paper cassette into the machine, see step 7 of "Loading Paper into the Paper Cassettes,". Installing the Toner Cartridge Install only a Canon FX7 Toner Cartridge in your machine. CAUTION Installing any other type of cartridge in this machine could damage the machine and void your warranty. Close the printer cover. The back of the tray sits on top of the extended lip of the main unit. Attaching the Document Feeder Tray NOTE Remove the tape on the back of the tray before attaching it to the main unit. If the setting is correct, proceed to step

3. [https://chatcharee.com/shop/fck\\_file/drivers-ed-manual-rhode-island.xml](https://chatcharee.com/shop/fck_file/drivers-ed-manual-rhode-island.xml)

## LASER CLASS® 700 Series

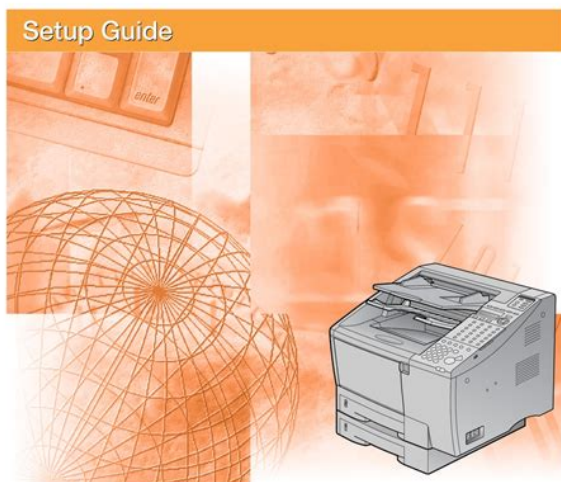

Please read this guide before operating this equipment.  
After you finish reading this guide, store it in a safe place for future reference.

ENG

If the setting is not correct, set the paper guides to match the size of the paper that you are loading. Reinsert the paper cassette into the main unit. Align the paper cassette with the rails on the main unit, then lift it slightly to insert the cassette. When you see the message This handset is to be used with the Canon LASER CLASS 700 Series only. Attach the handset cradle holder to the back of the cradle with the screws provided. Place the handset on the handset cradle. If you need assistance, contact your local authorized Canon dealer or telephone company. 148 Assembling the Machine. If you have installed the optional DualLine Upgrade Kit, you can connect another telephone line to your machine. See "Connecting Two Telephone Lines," on p. Connect the other end of the power cord to the power source. After you connect the power cord to the power source, the LCD display turns ON. CAUTION The machine must be connected to a properly grounded, threeprong 120 V AC outlet. If the Error lamp starts blinking red, wait for one of the following messages to appear. Message Description INSTALL CARTRIDGE You have not yet installed the toner cartridge. Operation Panel Parts and Functions.22 OneTouch Panels Closed. B B B B Clear For the LASER CLASS 710, the installation of the Clears an entire entry during information Printer Kit III is necessary to use these keys. NOTE If you do not press a key for 120 seconds, the machine automatically returns to the Standby mode. In a display that requires a name entry, the letter or number in the upper right corner of the LCD display tells you the entry mode. To enter the rest of the until you see a lower case. To see some of the keys described below, you may have to open all three onetouch speed dialing panels. Each time you change the size of the paper you load in the paper cassettes, it is necessary to change the paper size setting using the CASSETTE menu in the PAPER SETTINGS menu. Adjust the paper guides to the size of the paper.

The paper sensor for the MP tray is located to the right of the paper feed roller, when viewed from the front of the machine. Remove and store any remaining print media. The machine automatically switches to face up delivery. The faceup tray is particularly useful for heavier paper. To open the faceup tray, take hold of its tab, and pull down the tray 1. Grasp the end of the faceup tray, and pull it out until it locks 2. If you need assistance, contact your local authorized Canon dealer or telephone company. Locate the telephone line jacks on the right side of the main unit. Data Entry Keys Description 0 9 Enters a number. Space Enters a space spaces are optional. Deletes the rightmost digit of the number you are entering so you Delete can enter a new digit. Select a slower

speed. Setting the TX Line Priority This section describes how to set the TX line priority of the two lines. You can set to have the machine automatically select the line or you can manually select the line when you send a fax. The TX LINE SELECTION menu includes the following items

Item	Description
TX LINE SELECTION	You can select a preferred line for sending faxes or TX LINE SELECTION disable the transmission of outgoing faxes altogether. This ensures that the machine consumes less power when it is not being used.
Energy Saver Feature	Turning the Energy Saver Feature ON Open all three onetouch speed dialing panels. If you want to use the Auto Clear function, select, and proceed to step 4. If you do not want to use the Auto Clear function, select, and proceed to step 5.

Flow of Checking Operations.32

Canceling a Job. You can check the status of fax jobs or copy jobs on the LCD display. NOTE The Monitor screen does not appear during scanning. The scanning stops and the job will be canceled. The selected job will be canceled. NOTE You cannot select multiple jobs and cancel them all at once.



<http://superbia.lgbt/flotaganis/1649122838>

Some of these features also enable you to keep track of fax transactions based on division numbers or user access codes that you can assign to individuals or sections inside your company. Setting and Using the System Administrator's ID and Password. You need to enter the System Administrator's ID and password when you are using Department ID management and want to operate the machine as the System Administrator. In this case, you do not need to enter the System Administrator's password when accessing the SYSTEM SETTINGS menu. If you are canceling the System Administrator's ID, the setting is completed. Then we show you how to temporarily turn ON or OFF the restrictions, how to restrict the use of the telephone, and how to operate the machine with restrictions ON. Open all three onetouch speed dialing panels. Open all three onetouch speed dialing panels. To reset the counter, select. However, there may be occasions when you want the machine to store all documents in memory until you are ready to print them. Locking the machine to receive and store all documents in memory is called "Memory Lock.". This setting affects only reports that print automatically, such as activity reports for sending and receiving, and Activity Management Reports. OUTPUT YES A report prints while the machine is in the Memory Lock mode. To protect privileged access to the telephone lines, only authorized users are entrusted with the PIN codes for daily operations. Some PBX Private Branch Exchange systems require that a PIN code be entered when dialing a number to make a call or sending a document by fax. For instructions explaining how to place your documents on the machine, see Chapter 3,



"Sending Documents,". NOTE To enter the PIN code immediately, press Start. For instructions explaining how to place your documents on the machine, see Chapter 3, "Sending Documents,". NOTE To enter the PIN code immediately, press Start.

<https://goodacreuk.com/images/bunn-soft-heat-brewer-manual.pdf>



For instructions explaining how to place your documents on the machine, see Chapter 3, "Sending Documents,". The PIN code is not displayed as you enter it. The PIN code must be entered either before or after the number, depending on how PIN code access has been set up. The PIN code is not displayed as you enter it. Opening the Additional Functions Menu. 52 Paper Settings. Open all three onetouch speed dialing panels. Setting Procedure Open all three onetouch speed dialing panels. The MP tray can be used as a paper supply for fax, copy, report, and printer functions. MP PAPER SIZE Select the paper size you are loading in the MP tray. Setting Procedure Open all three onetouch speed dialing panels. Setting Procedure Open all three onetouch speed dialing panels. Setting Procedure Open all three onetouch speed dialing panels. PASSWORD You do not have to do this if the system settings are not yet password protected. See Chapter 4, "Restricting the Use of the Machine." 1. SYS. Storing Recording Paper. 62 Recommended Paper. For instructions on how to load the recording paper, see "Loading Paper into the Paper Cassettes," on p. 140, and "Loading Paper into the MP Tray," on p. CAUTION Keep toner and other consumables out of the reach of small children. If these items are ingested, consult a physician immediately. As you steady the cartridge with one hand, remove the tape by gently pulling the plastic tab straight out with your other hand. Gently slide the cartridge into the main unit until it is completely down and in a level position. Close the printer cover. Disposing of Used Toner Cartridges To protect the environment, Canon has started a special program to help you dispose of your empty toner cartridges. After you install a toner cartridge, keep the original packaging material and the shipping label. Handling Cartridges Always place toner cartridges down with the FX7 toner label on the cartridge facing up. Handle the toner cartridge with care.

<http://goldenstateav.com/images/bunn-tying-machine-manual.pdf>



Before you clean the machine, print all of the documents received and stored in memory. Cleaning the Main Unit Before you clean the machine, disconnect the power cord of the main unit from the power source. Lift the document feeder tray and document output tray. Open the printer cover, and remove the toner cartridge. Wipe the edge of the transfer guide with a soft, clean cloth, to remove toner and paper dust from both sides of the transfer guide. Then, gently place the transfer guide 2 2 2 2 back into its original position. Silver Metal Strip Transfer Charging Roller IMPORTANT To avoid the deterioration of print quality, never touch the transfer charging roller when you clean the metal strip. If the underside of the ADF Automatic Document Feeder cover or the scanning glass is dirty, the documents you send may look dirty. Check if some streaked lines which do not exist on the original appear on the output when scanning the original using the ADF. Top Unit Correct Incorrect Lower Unit Lower unit is not lifted. Lower unit is lifted. CAUTION Be sure not to open the ADF cover fully to the extent that the lower unit is lifted, as shown in the illustration on the right. Open the top unit of the ADF cover, and clean all the rollers. Use a dry cloth to wipe clean the underside of the ADF cover and to wipe up the paper dust around the rollers. CAUTION Make sure that the top unit of the ADF cover is locked into position securely before proceeding to step 6. Lift the document feeder tray, and gently open the ADF cover until it stops, grasping the document feeder tray and the ADF cover at the same time. Use a soft, dry cloth that will not scratch the scanning glass to wipe clean the underside of the ADF cover and to wipe up the paper dust around the rollers. Close the ADF cover, and press down on it slightly until you hear it lock into place. Then, lower the document feeder tray.

IMPORTANT Make sure that you have put the black, plastic loop back in place before you close the ADF cover. In such a case, clean the roller. Load letter size paper in the MP Tray to clean the roller. IMPORTANT clean the roller Only letter size paper can be used to NOTE It takes about 150 seconds to clean the roller. Open all three onetouch speed dialing panels. Please contact your local authorized Canon dealer when you run out of ink. Disconnect the power cord of the main unit from its power source. CAUTION To avoid spilling ink, apply only one drop of ink to the stamp pad. Then, lower the document feeder tray. IMPORTANT Make sure that you put the black, plastic loop back in place when you close the ADF cover. Clearing Document Feed Jams. 72 Initializing the Automatic Document Feeder. If a paper jam occurs during scanning, the Error lamp blinks red, and the following message appears on the LCD display Follow the procedure described below to clear the document feed jam. NOTE Always open the ADF cover before you attempt to remove a jammed document. Close the ADF cover, and press down on it gently until you hear it lock into place. Open all three onetouch speed dialing panels. You should check each location for jammed paper, and remove it carefully. If a paper jam occurs in any of the areas shown below, use the table to direct you to the proper section to help you clear the jam. This happens when the trailing edge of the paper is still within the paper feed area. Follow the procedure from step 2 on p. Hold up the faceup tray slightly 1 1 1 to release the lock pin 2 2 2 3 3 3 3 which is located on the right side of the tray. Remove the jammed paper. The hooks automatically catch the lock pins. Imaging Area Lift the document feeder

tray and document output tray. Open the printer cover, and remove the toner cartridge. If you see the edge of the jammed paper in the imaging area, remove the paper by pulling it slowly.

<https://www.edutechusa.com/wp-content/plugins/formcraft/file-upload/server/content/files/16271ffa97e017---brave-24-ton-log-splitter-manual.pdf>

For details on clearing a paper jam in the Imaging area, see "Imaging Area," on p. NOTE If the paper does not come out easily, or you cannot grasp the edge of the paper easily, do not force it out. When errors are recorded in reports, note the error code number, and check it against the table below to learn more about what caused the error and how to remedy it. Remedy Contact your local authorized Canon dealer where you purchased your Canon product for assistance. If the message remains on the LCD display and the machine does not return to the Standby mode, call your local authorized Canon dealer. CHECK PRINTER COVER Cause The printer cover is not closed completely. Remedy You have to enter the Department ID and password if set in order to operate the machine. HANG UP PHONE Cause The transaction has completed, but the handset is not sitting completely on its cradle. Copying Documents You cannot copy. Cause The toner cartridge is out of toner. The file is then sent using network data lines. Because the Canon The Canon LASER CLASS 700 Series utilizes the ITUT.37 standard LASER CLASS 700 Series offers both Ifax and Super G3 sending, for Internet Fax transmissions. Discover everything Scribd has to offer, including books and audiobooks from major publishers. Start Free Trial Cancel anytime. Report this Document Download Now save Save Canon Laser Class 700 Series Manual For Later 0 ratings 0% found this document useful 0 votes 142 views 358 pages Canon Laser Class 700 Series Manual Uploaded by Anthony Brown Description Full description save Save Canon Laser Class 700 Series Manual For Later 0% 0% found this document useful, Mark this document as useful 0% 0% found this document not useful, Mark this document as not useful Embed Share Print Download Now Jump to Page You are on page 1 of 358 Search inside document Browse Books Site Directory Site Language English Change Language English Change Language. This page requires Javascript.

Modify your browsers settings to allow Javascript to execute. See your browsers documentation for specific instructions. To install your download click on the name of the downloaded file. Canon Authorized Dealers provide the highest quality service and are supported by Canon certified technicians using Canon Genuine parts. Please contact your Canon Authorized dealer for all your service needs. Need to find a dealer The driver may be included in your OS or you may not need a driver. Recommended Drivers File Name Date File Size Optional Drivers File Name Date File Size Recommended Software File Name Date File Size Optional Software File Name Date File Size. Page Count 365 Facsimile Guide. Please read this guide before operating this equipment. After you finish reading this guide, store it in a safe place for future reference. Facsimile Guide The manuals for this machine are divided as follows. Depending on the system Guides with this symbol are printed manuals. Installing the CDROM Software. Instructions The machine illustration on the cover may differ slightly from your machine. Reference Guide. Sending Guide. Facsimile Guide Setup Guide Chapter 1. Before You Start Using This Machine. Chapter 2. Using Speed Dialing. Chapter 3. Sending Documents. Chapter 4. Receiving Documents. Chapter 5. Using the Machine as a Copier. Chapter 6. Using a Relay Network. Chapter 7. Using Confidential Mailboxes. Chapter 8. Using Polling. Chapter 9. Chapter 10 Other Special Features. Chapter 11 Summary of Important Settings. Chapter 12 Printing Reports and Lists. Chapter 13 Troubleshooting. Chapter 14 Appendix. Includes the specifications of the machine, the type of documents you can Considerable effort has been made to ensure that this manual is free of inaccuracies and omissions. However, as we are constantly improving our Preinstallation Requirements for Canon Facsimile Equipment..... xvii. Chapter 1. Using the Menus and Operation Panel Keys. General Guidelines for Registering Information.

Open a Menu and Select an Item..... Registering Required Sender Information TX  
TERMINAL ID..... 116 Registering the Machine's Telephone Number and Unit Name..... 119.



Checking and Setting the Telephone Line.....121. Changing or Erasing a Sender's Name.....127. Registering Telephone Numbers for the Lines.....130. Read This Before Entering Telephone Numbers.....22. Sending DocumentsCanceling a Job from the Monitor Screen.....Messages Displayed After Pressing the Start Key.....Sequential Broadcasting to More Than One Location..... 326. Receiving a Document Manually with the Optional Handset. Receiving a Document Manually with an Extension Telephone.....Chapter 5. Using the Machine as a CopierUsing a Relay Network. Setting Up and Using a Standard Relay Unit.....63. Sending a Document to a Relay Unit for Relay Broadcasting.....611. Sending a Document to a Relay Unit with Speed Dialing.....612. Sending with the Advanced Communication Key.....612. Setting Up and Using the Confidential Mailbox Feature.....72. Sending a Confidential Document with Speed Dialing.....712. Sending a Confidential Document with the Advanced Communication Key.713. Polling Other Fax Machines to Receive a Document.....83. Scanning a Document into the Memory for Polling Sending.....818. Setting Up the Machine for Document Transfer.....93Setting a Time and Password for Memory Lock. Turning Memory Lock OFF and Printing Documents.....Sending a Document in Memory to a Different Destination..... 920. Deleting a Document with the Delete File Key..... 922. Deleting a Document with the Memory Reference Key..... 923. Before You Set Up the TX Document Archiving.

Turning the TX Document Archiving ON. Turning the TX Document Archiving OFF.....How Your Registered Data Is Protected..... 930. Dialing with a PIN Code after the Number..... 108. Dialing with a PIN Code before the Number..... 109. Setting PIN Code Access for Speed Dialing..... 1011. Using Speed Dialing with PIN Code Access..... 1012. Setting Up the Program OneTouch Key..... 1015. Setting Up and Using the Optional Stamp Feature.....Opening the Additional Functions Menu.....112. Printing the Activity Management Report.....129. List of LCD Display Messages Alphabetical List.....138Thank you for purchasing the Canon LASER CLASS 700 Series. Please read this manualAfter reading this manual, store it in a safe placeHow to Use This Manual. Symbols Used in This Manual. The following symbols are used in this manual to explain procedures, restrictions,In order to use the machineIn order toBe sure to readReading these notes is highlyKeys Used in This Manual. The following symbols and key names are a few examples of how keys to beThe operation panel keys on the machineStart. Data. RegistrationUnless otherwise mentioned, illustrations used in this manual are those taken whenThe model LASER CLASS 710 is used for illustration purposes in this manual. When there is any difference between the three models, it is clearly indicated in theUsers in the U.S.A. A. Location. Supply a suitable table, cabinet, or desk for the machine. See Chapter 8. B. Order InformationDDD Direct Distance Dial lineA dedicated extension off a PBXC. Power Requirements. This machine should be connected to a standard 120 volt AC, threewire groundedDo not connect this machine to an outlet or power line shared with other appliances.

Air conditioners, electric typewriters, copiers, andThe REN is used to determine the number of devices that may be connected to aIn most but not all areas, the sum of RENsThis equipment may not be used on coin service provided by the telephoneThe telephone line should not be reconnected or theUsers should contactThe telephone company also retainsAlso, you will be advised of yourWarning for the LASER CLASS 710. Do not make any changes or modifications to the equipment unless otherwiseIf such changes or modifications should be made, youThis equipment has been tested and found to comply with the limits for a Class BThese limits are designed toHowever, there is noUse of shielded cable is required to comply with Class B limits in Subpart B of PartIf such changes or modifications should be made, youThis device complies with Part 15 of the FCC Rules. Operation is subject to theNote This equipment has been tested and found to comply with the limits

for a. Class B digital device, pursuant to Part 15 of the FCC Rules. These limits areThis equipment generates, uses and can radiate radioHowever, there is noUse of shielded cable is required to comply with Class B limits in Subpart B of PartIf such changes or modifications should be made, youCanon U.S.A. Inc. One Canon Plaza, Lake Success, NY 11042, U.S.A. TEL No. 5163285600Preinstallation Requirements for Canon Facsimile Equipment. B. Order InformationUse one line per unit. DDD Direct Distance Dial lineA dedicated extension off a PBXKey telephone systemsC. Power Requirements. The power outlet should be a threeprong grounded receptacle single or duplex. It should be independent from copiers, heaters, air conditioners or any electricalThe rated value is 120 volts and 15This equipment meets the applicable Industry Canada Terminal Equipment. Technical Specifications. This is confirmed by the registration number. TheIt does not imply that Industry Canada approvedAvis.

Le present materiel est conforme aux spcifications techniques d'Industrie CanadaCette conformit est confirme par le numroll n'impliqueBefore installing this equipment, users should ensure that it is permitted to beThe Ringer Equivalence Number REN of this terminal equipment is 0.3. The RENEven if the dualline option is installed, the REN is applicable to each port. Avis. L'indice d'equivalence de la sonnerie IES du present materiel est de 0.3. L'IESLa terminaison d'uneRepairs to certified equipment should be made by an authorized CanadianAny repairs or alterations made byThis precaution may be particularly important inCaution. Users should not attempt to make such connections themselves, but should contactThis Class B digital apparatus meets all requirements of the Canadian. InterferenceCausing Equipment Regulations. Cet appareil numerique de la classe B respecte toutes les exigences du ReglementSuper G3. Super G3 is a phrase used to describe the new generation of fax. Super G3 High Speed Fax machines allow transmission time ofNetwork PSTN currently supports 28.8 Kbps modem speeds orTrademarks. Canon, the Canon logo, RAPID Fusing System, and LASER CLASS are trademarks of. Canon Inc. Other product and company names herein may be the trademarks of their respectiveCopyright. Copyright 2005 by Canon Inc. All rights reserved. No part of this publication may be reproduced or transmitted in any form or by any means,The information in this document is subject to change without notice.This MachineRegistering Required Sender Information TX TERMINAL ID.....116Your machine is equipped with the ITUT International Telecommunication. UnionTelecommunication Standardization Sector standard V.34 mode which enablesBefore You Start Using This MachineQuality Images! You can employ ITUT subaddresses and passwords to communicate not only with other. Canon fax machines, but fax machines of other manufacturers.

SubaddressesIncludes onetouch and coded speed dialing, directory dialing, group dialing, and accessOneTouch Speed DialIncludes sequential broadcasting, polling, relay sending and receiving, and confidentialRelay Sending. Confidential Sending. Sequential Broadcasting. Polling. ECM Error Correction Mode reduces errors during sending and receiving on noisy orIf you run out of paper or toner while you are receiving a document, the machineIncoming. Document. ReceivingMem. Main FeaturesThis enables you to take advantage of holiday or late night telephone rates.Delayed Sending. Even while you are sending or receiving a document, you can continue to use theSending. Receiving. Recording. DocumentsFor PBXs Private Branch Exchanges that require PIN Personal Identification NumberFor better security, PIN codes are notPIN CodeJBIG is especially effective when transmitting halftone image documents. The smallerThis section provides you with the names and functions of the operation panelBefore You Start Using This MachineOn Line. Job. Alarm. Menu. PRT.Message. Item. Go. Value. Shift. Ultra Fine. Super Fine. Fine. Standard. Resolution. Darker. Lighter. Counter. Check. Text. Direct TX. Contrast Document Type. Set. Monitor. Delete FileEnergy Saver. RedialDirectoryIn Use. ErrorFor the LASER CLASS 710, the installation of the. Printer Kit III is necessary to use these keys.Press to check the counter information.Sets the machine to the Direct Sending mode soDirect SendingCursor Keys. Move the cursor left or right during dataEnable you to scroll through the display so youThey also enable you to search through theSelects a menu item

during data registration. Dial numbers registered under onetouch speedThe first panel displays keys 124. Open the firstOpen the secondOpen the third panelPress to enter or cancel the Energy Saver mode. When the machine is in the Energy Saver mode, Enables the machine to act as a copier, so youA Speaker Volume Switch. Adjusts the speaker's volume. B Clear.

<https://www.becompta.be/emploi/bosch-maxx-6-user-manual-pdf>